

# IPAD WIPE AND RESET

## IPAD WIPE AND RESET

This procedure will outline the steps needed to wipe and reset an iPad and enroll into Jamf. Please read all the instructions before proceeding.

\*\*The user must have the ability to install software on the device.

1. Select the "Setting" icon

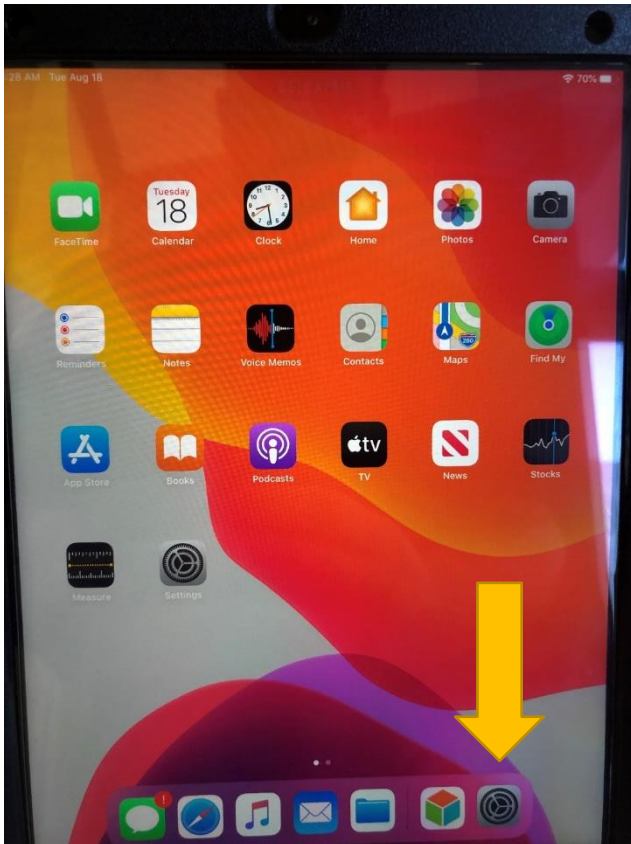

a.

2. Select "General".
3. Select "Reset".

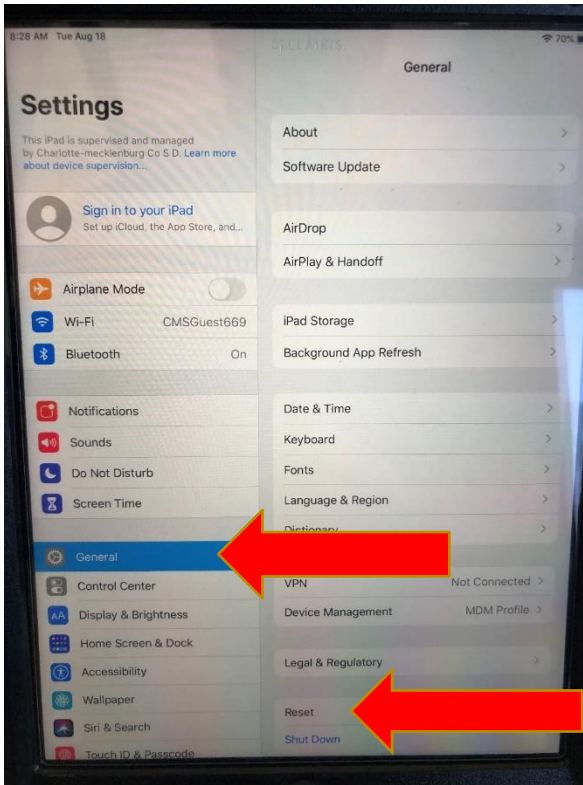

a.

4. Select "Erase All Content and Settings"

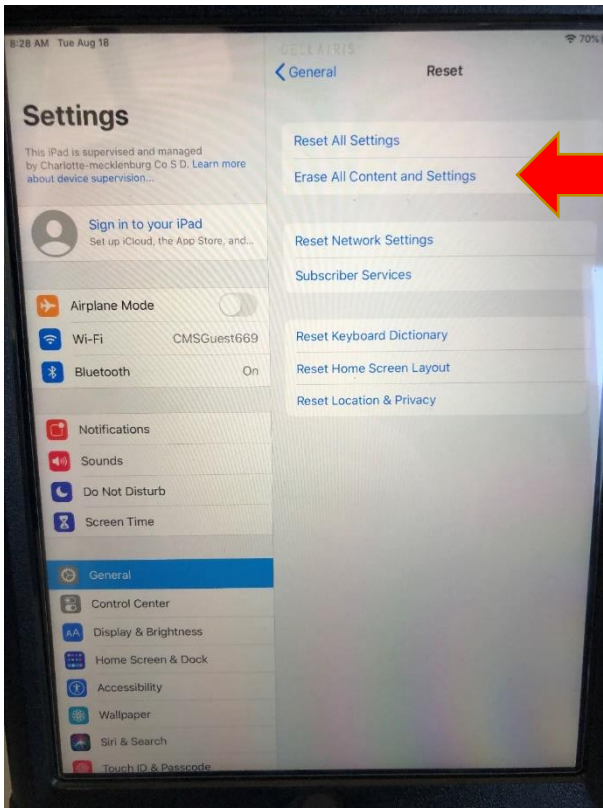

a.

5. Select "Erase"

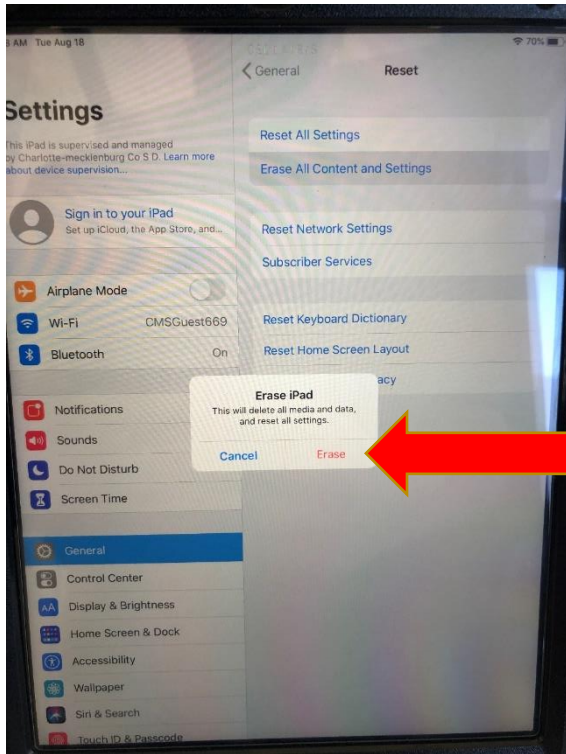

a.

6. Select "Erase" again.

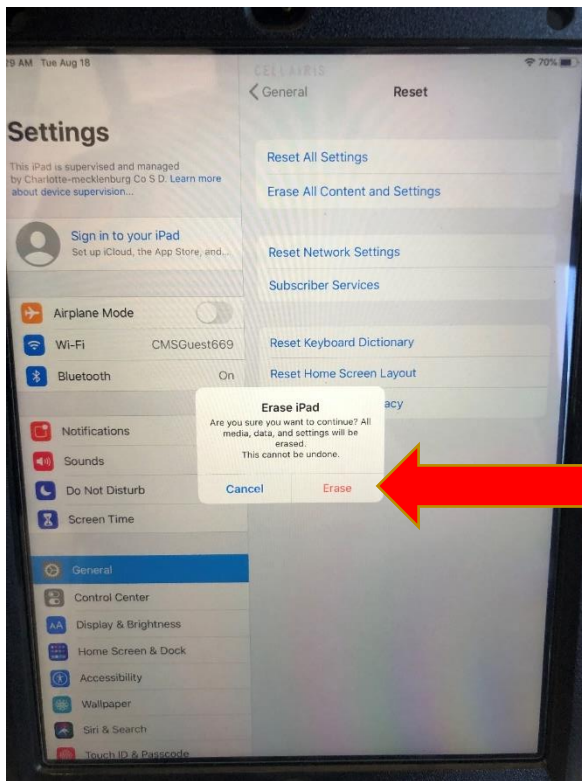

a.

7. After the iPad has reset and rebooted press the Home button.

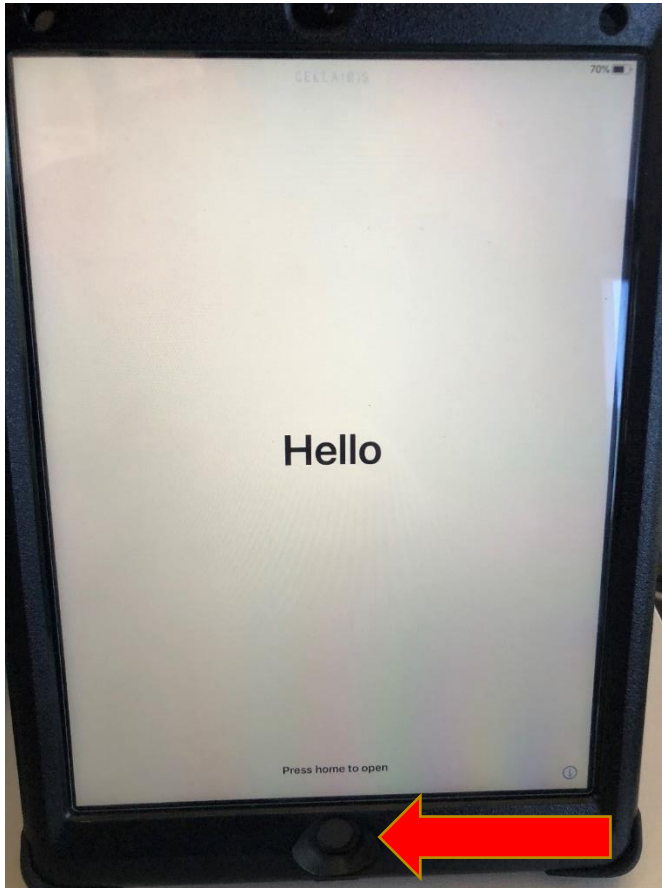

a.

8. Select "English".

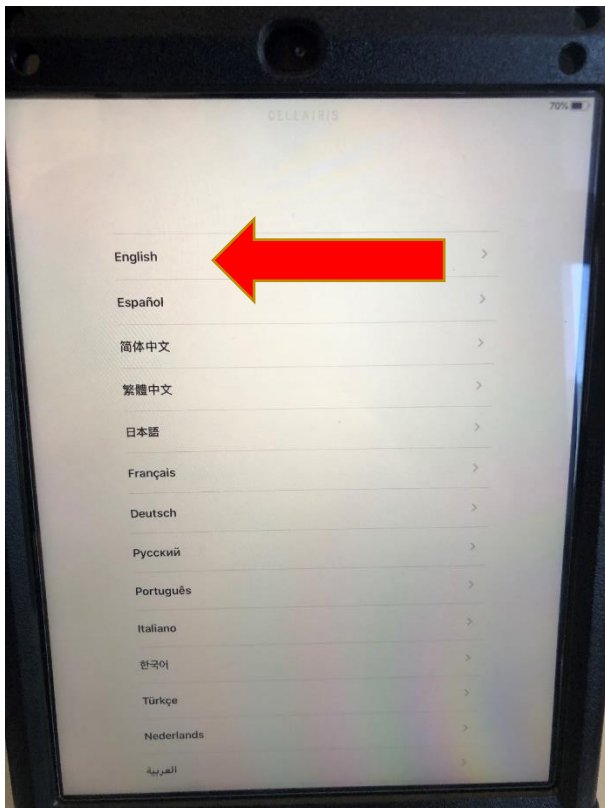

a.

9. Select "United States".

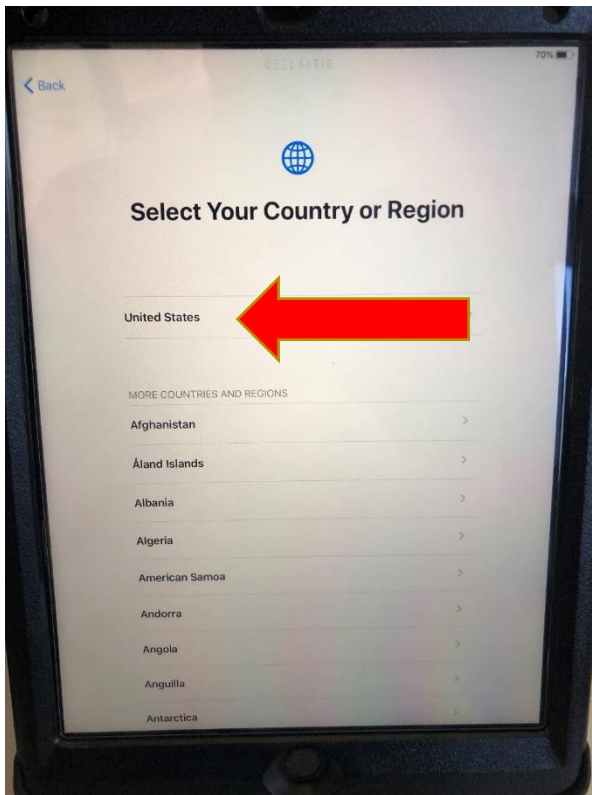

a.

10. Select "Set Up Manually".

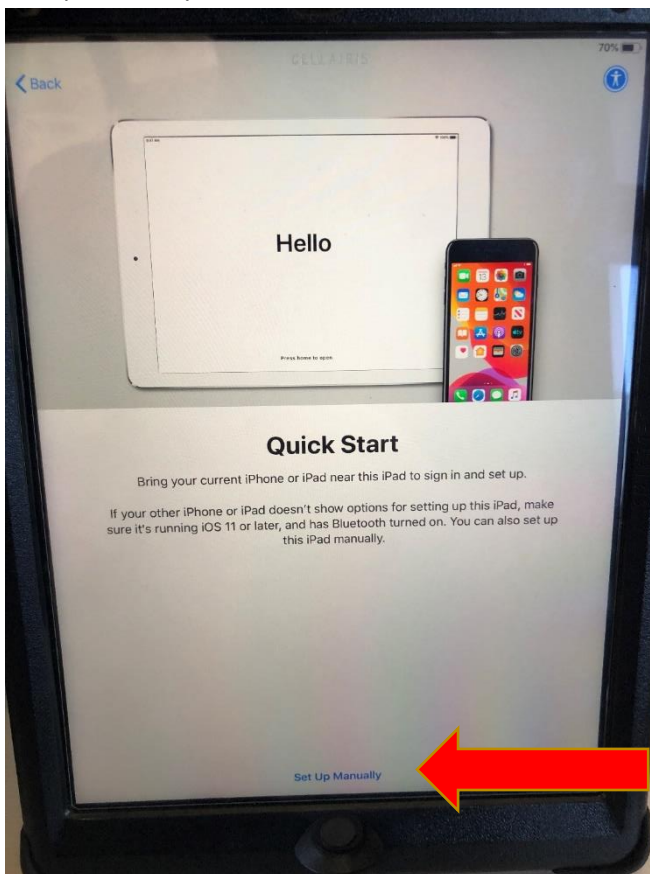

a.

11. Choose your home wireless network from the list. (Hotspot is just an example)

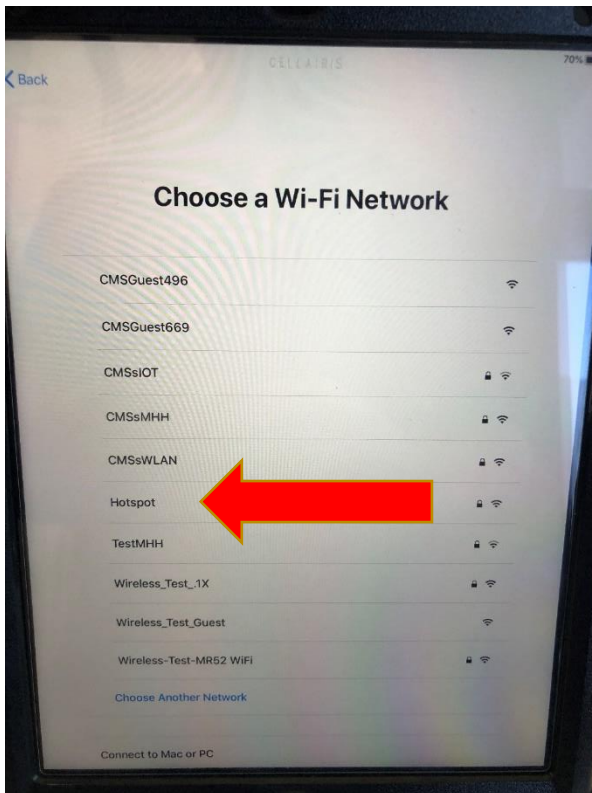

- a.
- b. Enter the password for your home wireless network if applicable.

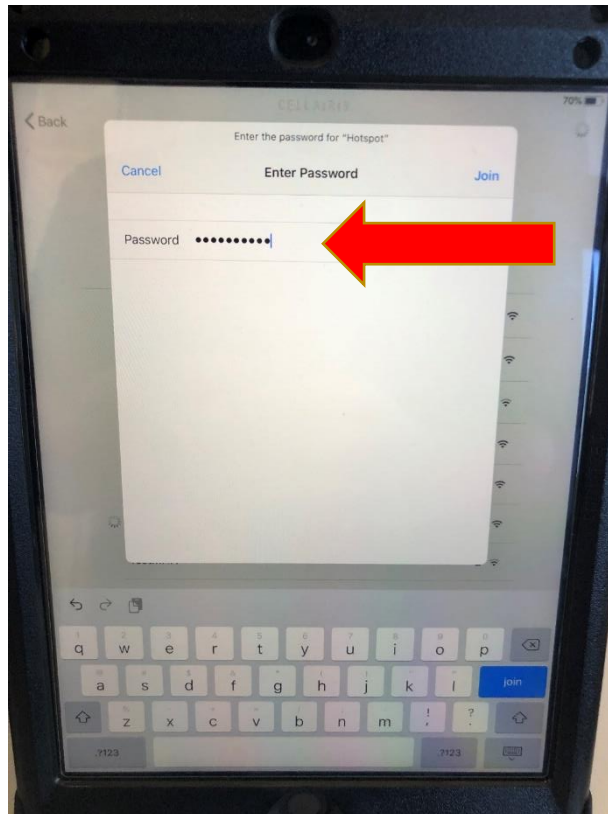

i.

12. The iPad should activate in a few minutes.

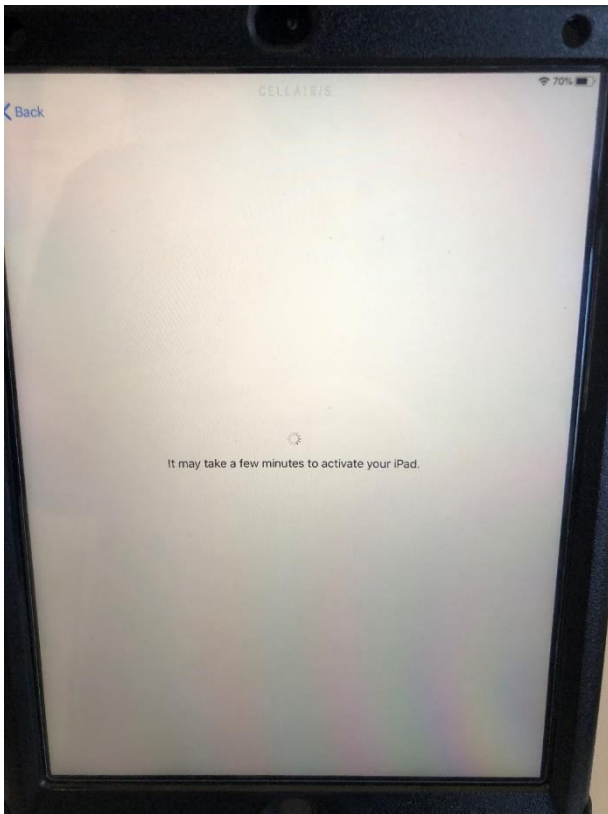

a.

13. The iPad will retrieve the configuration.

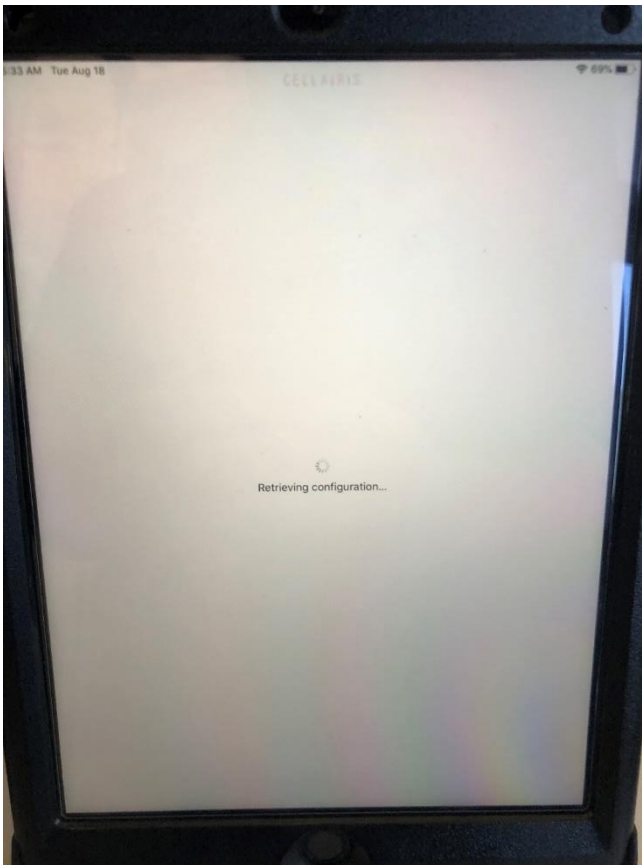

a.

14. Select "Next".

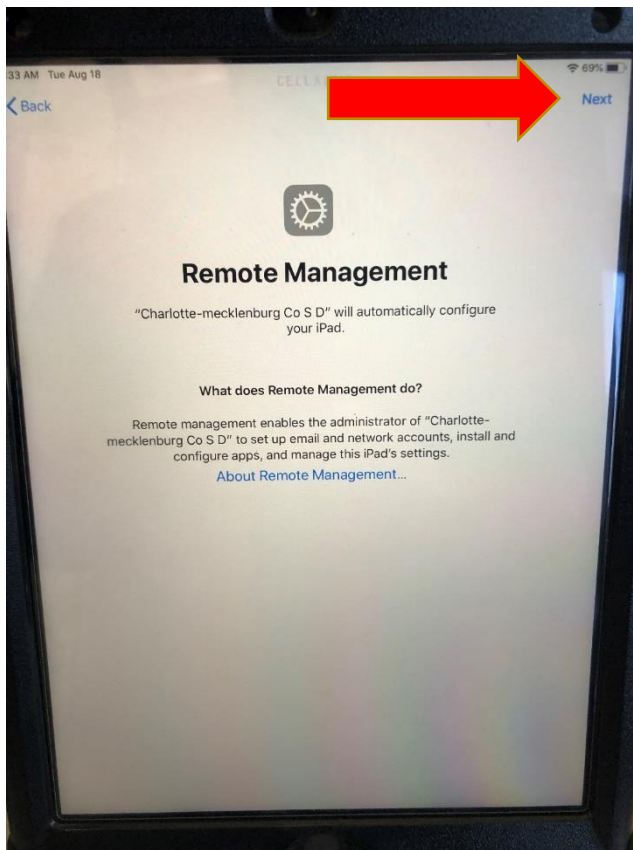

a.

15. The configuration profile from CMS will install.

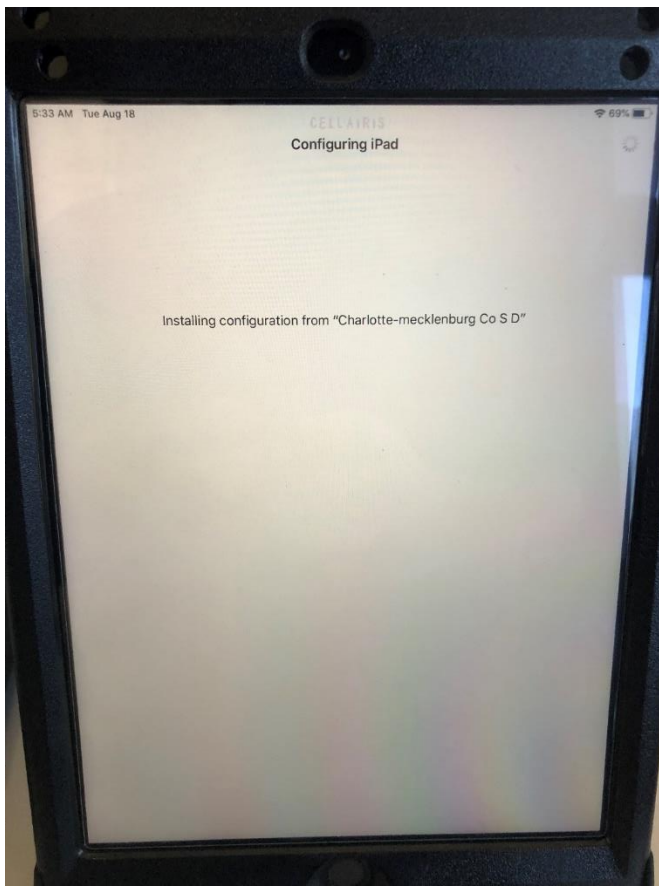

a.



16. Select "Enable Location Services."

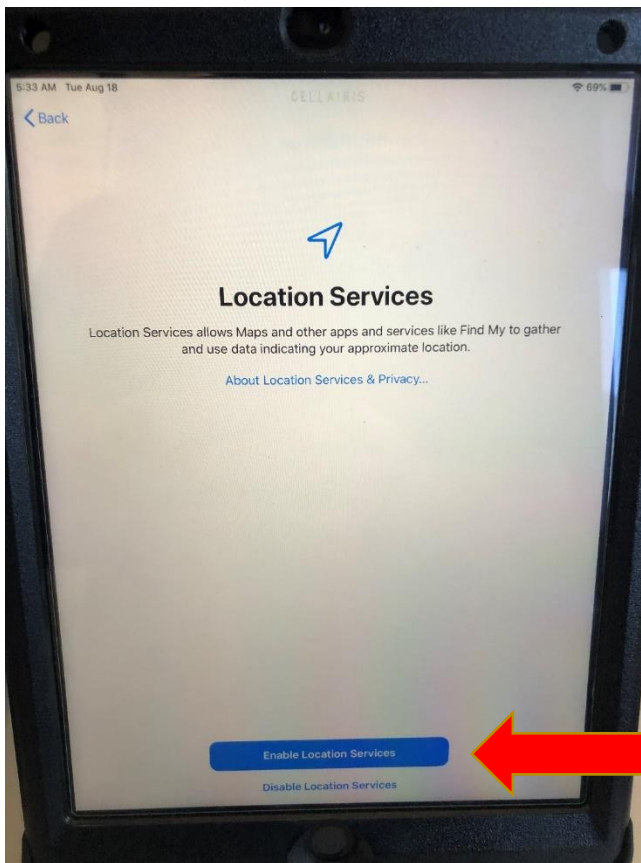

a.

17. The iPad is now configured for CMS use and apps will begin to install to the device.